

West Wetlands Disc Golf

Signatures:

Date:

Par	3	3	3	3	4	3	3	3	3	28	3	3	3	3	4	3	3	3	3	28	56	
Player:																						
Hole	1	2	3	4	5	6	7	8	9	In	10	11	12	13	14	15	16	17	18	Out	Total	
Player:																						

- Mandatory dogleg are designated by yellow stakes.
 - #1,2 and 9 are dogleg right (your disc must pass on the left of the stake)
 - #4,6 and 8 are dogleg left (your disc must pass on the right of the stake)
- Until the dogleg is passed the closest foot to the dogleg must be on the lie when the disc is released.
- The out of bounds are the post and cable fence (road) to the north and the chain link fence to the south (canal).
- Each shot that come to rest out of bounds will incur a one throw penalty.
- A throw that lands out of bounds, must be played from a point 3 feet in bounds from where the disc went out of bounds

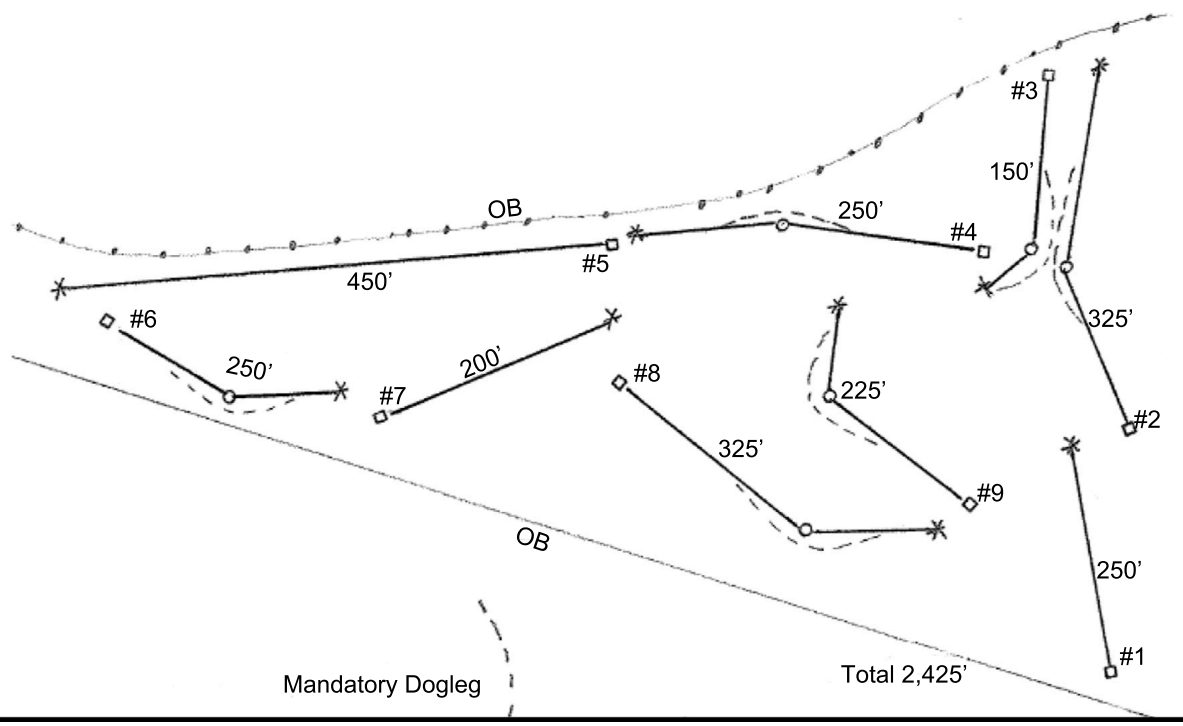

Yuma Parks and Recreation



Mandatory Dogleg

Total 2,425'